

# PWM | PULSE WIDTH MODULATION

HVAC + R

STANDARD



## MAIN FUNCTIONS

ENGINE SPEED CONTROL

HIGH VOLTAGES

HIGH RELIABILITY

## CHARACTERISTICS

- Metal or Plastic housing
- Resinated product providing high IP rating
- Automotive connector
- One Wire Interface

## CONFIGURATION OPTIONS

INPUTS: Analogs and Digitals

OUTPUTS: Analogs, Positive Digitals, Negative Digitals and PWM

## AVAILABLE FOR



# PWM MODULE

# ALUMINUM

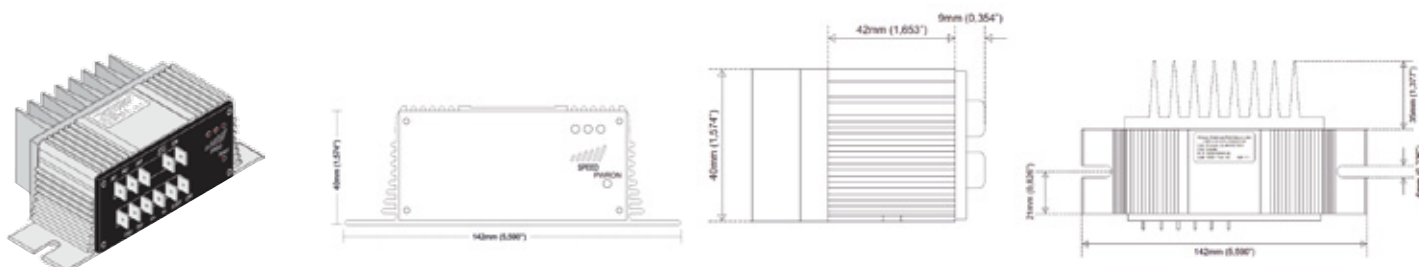

Approximated weight: 400g

## CONNECTORS



POSITIVE LOCK AMP 1 VIA  
Part Number: 154719-1  
Terminal – PN: 880645-6  
Manufacturer: AMP

TECHNICAL DATA	
OPERATING VOLTAGE	9V to 30V
VOLTAGE RANGE	10 Vdc to 28 Vdc
MAXIMUM VOLTAGE	32 Vdc during 5 mins
MAXIMUM CURRENT PER OUTPUT	30A
OUTPUT SHORT-CIRCUIT	Protected*
REVERSE POLARITY	Protected*
OPERATING TEMPERATURE	-40°C to +85°
STORAGE TEMPERATURE	-40°C to +85°C / -40°F to +185°F
TEMPERATURE SENSOR	N/A
PROTECTION DEGREE	IP 65
CONNECTOR	AMP
COMMUNICATION	One Wire
MAXIMUM CURRENT CONSUMPTION	45mA @12v / 55mA 24v
STANDBY CONSUMPTION	N/A

\* According to product configuration. \*\* Consumption may vary according to customer specifications.  
We keep the right to update or change information regarding products without prior notice.



PWM MODULE

PLASTIC

GL-M1HGL002

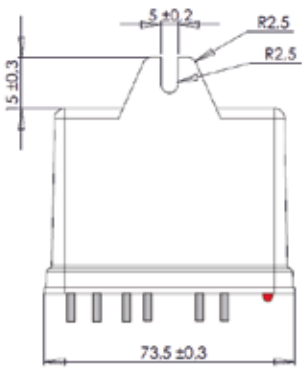
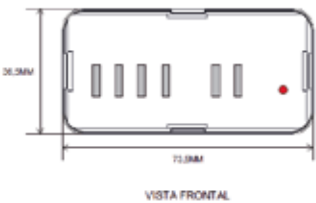

Approximated weight: 200g

CONNECTORS



POSITIVE LOCK AMP 1 VIA  
Part Number: 154719-1  
Terminal – PN: 880645-6  
Manufacturer: AMP

TECHNICAL DATA	
OPERATING VOLTAGE	12 Vdc / 24 Vdc
VOLTAGE RANGE	11 Vdc to 30 Vdc
MAXIMUM VOLTAGE	32 Vdc during 5 mins
MAXIMUM CURRENT PER OUTPUT	15A
OUTPUT SHORT-CIRCUIT	Protected*
REVERSE POLARITY	Protected*
OPERATING TEMPERATURE	-40°C to +85°
STORAGE TEMPERATURE	-40°C to +85°C / -40°F to +185°F
TEMPERATURE SENSOR	N/A
PROTECTION DEGREE	IP 54
CONNECTOR	AMP
COMMUNICATION	N/A
MAXIMUM CURRENT CONSUMPTION	40mA @12v / 60mA 24v
STANDBY CONSUMPTION	N/A

\* According to product configuration. \*\* Consumption may vary according to customer specifications.  
We keep the right to update or change information regarding products without prior notice.

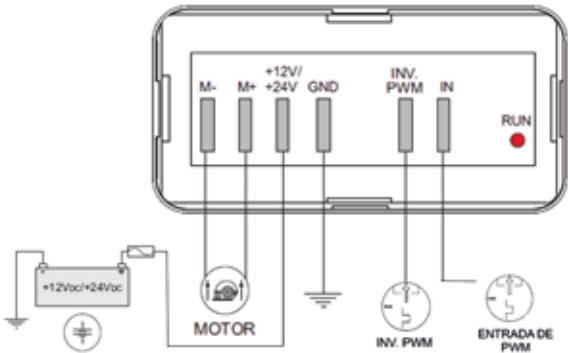

# PWM MODULE PLASTIC

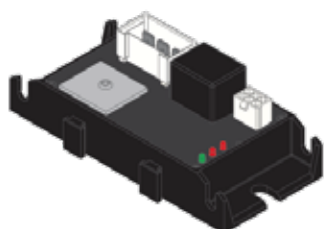

Approximated weight: 160g

## CONNECTORS



FASTON 6 VIAS  
Part Number: 0-280314-0  
Terminal PN: 880645-6  
Manufacturer: AMP

### TECHNICAL DATA

OPERATING VOLTAGE	12 Vdc
VOLTAGE RANGE	10 Vdc to 15 Vdc
MAXIMUM VOLTAGE	17 Vdc during 5 mins
MAXIMUM CURRENT PER OUTPUT	15A
OUTPUT SHORT-CIRCUIT	Protected*
REVERSE POLARITY	Protected*
OPERATING TEMPERATURE	-40°C to +85°
STORAGE TEMPERATURE	-40°C to +85°C / -40°F to +185°F
TEMPERATURE SENSOR	N/A
PROTECTION DEGREE	IP 54
CONNECTOR	FASTON
COMMUNICATION	One Wire
MAXIMUM CURRENT CONSUMPTION	110mA @12v
STANDBY CONSUMPTION	1,7mA

\* According to product configuration. \*\* Consumption may vary according to customer specifications.  
We keep the right to update or change information regarding products without prior notice.

