

# PWM | PULSE WIDTH MODULATION

HVAC + R

STANDARD



## MAIN FUNCTIONS

ENGINE SPEED CONTROL

HIGH VOLTAGES

HIGH RELIABILITY

## CHARACTERISTICS

- Metal or Plastic housing
- Automotive connector
- Resinated product providing high IP rating
- One Wire Interface

## CONFIGURATION OPTIONS

INPUTS: Analogs and Digitals

OUTPUTS: Analogs, Positive Digitals, Negative Digitals and PWM

## AVAILABLE FOR



# PWM MODULE ALUMINUM

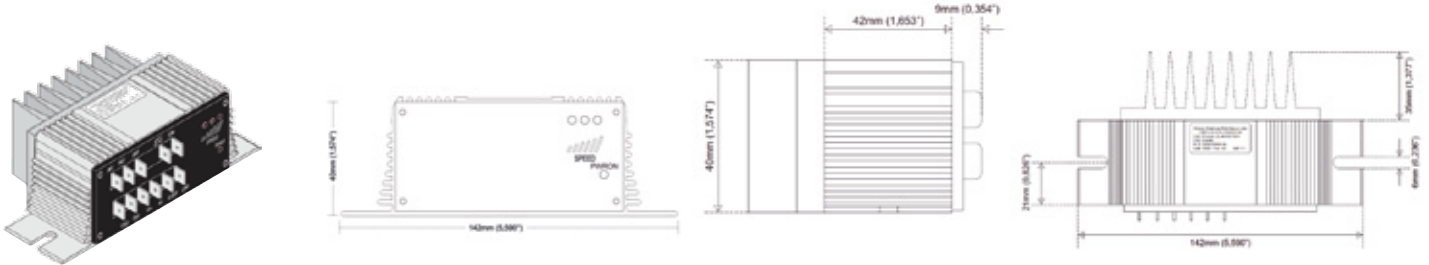

Approximated weight: 400g

## CONNECTORS



POSITIVE LOCK 1 way  
Part Number: 154719-1  
Terminal – PN: 880645-6  
Manufacturer: AMP

TECHNICAL DATA	
OPERATING VOLTAGE	12 VDC / 24 VDC
VOLTAGE RANGE	11 VDC to 30 VDC
MAXIMUM VOLTAGE	32 VDC during 5 min
MAXIMUM CURRENT PER OUTPUT	30A
OUTPUT SHORT-CIRCUIT	Protected*
REVERSE POLARITY	Protected*
OPERATING TEMPERATURE	-40°C to +85°
STORAGE TEMPERATURE	-40°C to +85°C / -40°F to +185°F
TEMPERATURE SENSOR	N/A
PROTECTION DEGREE	IP 65
COMMUNICATION	One Wire
MAXIMUM CURRENT CONSUMPTION	40mA @ 12VDC / 60mA @ 24VDC
STANDBY CONSUMPTION	N/A

\* According to product configuration. \*\* Consumption may vary according to customer specifications.  
We keep the right to update or change information regarding products without prior notice.



PWM MODULE

PLASTIC

GL-M1HGL002

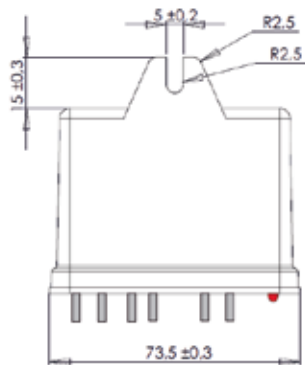
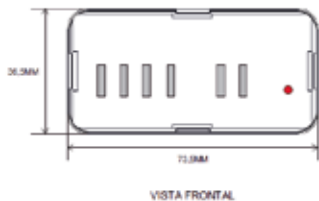

Approximated weight: 200g

CONNECTORS



POSITIVE LOCK 1 way  
Part Number: 154719-1  
Terminal – PN: 880645-6  
Manufacturer: AMP

TECHNICAL DATA	
OPERATING VOLTAGE	12 VDC / 24 VDC
VOLTAGE RANGE	11 VDC to 30 VDC
MAXIMUM VOLTAGE	32 VDC during 5 min
MAXIMUM CURRENT PER OUTPUT	15A
OUTPUT SHORT-CIRCUIT	Protected*
REVERSE POLARITY	Protected*
OPERATING TEMPERATURE	-40°C to +85°
STORAGE TEMPERATURE	-40°C to +85°C / -40°F to +185°F
TEMPERATURE SENSOR	N/A
PROTECTION DEGREE	IP 54
COMMUNICATION	N/A
MAXIMUM CURRENT CONSUMPTION	40mA @ 12VDC / 60mA @ 24VDC
STANDBY CONSUMPTION	N/A

\* According to product configuration. \*\* Consumption may vary according to customer specifications.  
We keep the right to update or change information regarding products without prior notice.

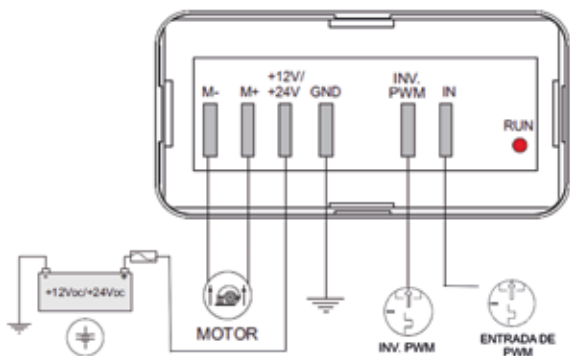

# PWM MODULE PLASTIC

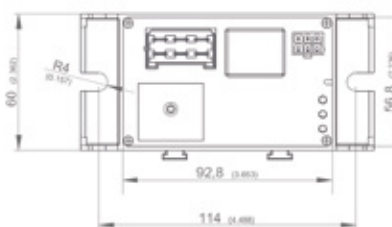
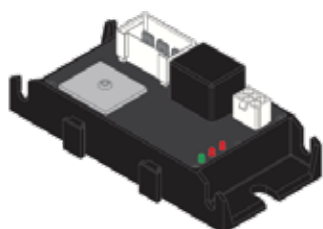

Approximated weight: 160g

## CONNECTORS



FASTON 6 ways  
Part Number: 0-280314-0  
Terminal PN: 880645-6  
Manufacturer: AMP

TECHNICAL DATA	
OPERATING VOLTAGE	12 VDC
VOLTAGE RANGE	10 VDC to 15 VDC
MAXIMUM VOLTAGE	17 VDC during 5 min
MAXIMUM CURRENT PER OUTPUT	15A
OUTPUT SHORT-CIRCUIT	Protected*
REVERSE POLARITY	Protected*
OPERATING TEMPERATURE	-40°C to +85°
STORAGE TEMPERATURE	-40°C to +85°C / -40°F to +185°F
TEMPERATURE SENSOR	N/A
PROTECTION DEGREE	IP 54
COMMUNICATION	One Wire
MAXIMUM CURRENT CONSUMPTION	110mA @ 12VDC
STANDBY CONSUMPTION	1,7mA

\* According to product configuration. \*\* Consumption may vary according to customer specifications.  
We keep the right to update or change information regarding products without prior notice.





WE ARE TODAY.  
WE ARE TOMORROW.  
WE ARE GLOBUS!



**Globus**  
Electronics



Av. Pernambuco, 106 | Navegantes | Porto Alegre | Brasil  
Fone: +55 51 3205 0555



Phone: +1 754 600 9882

[www.globuselectronics.com](http://www.globuselectronics.com)

